

242-S SERIES CARTRIDGE PUMPS

Push Style Linkage:
Push to Pressurize
Pull to Fill Cylinder

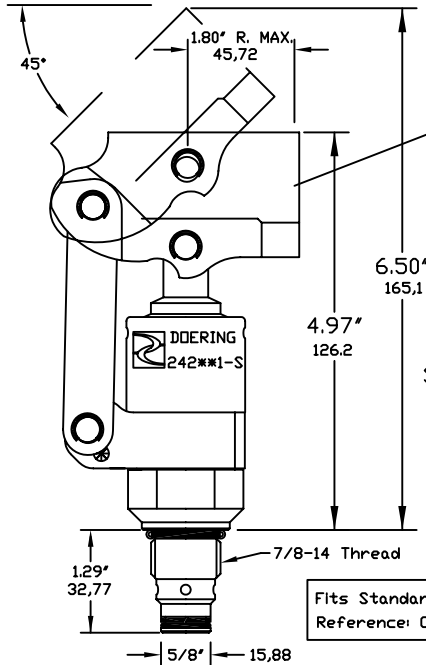

Pull Style Linkage:
Pull to Pressurize
Push to Fill Cylinder

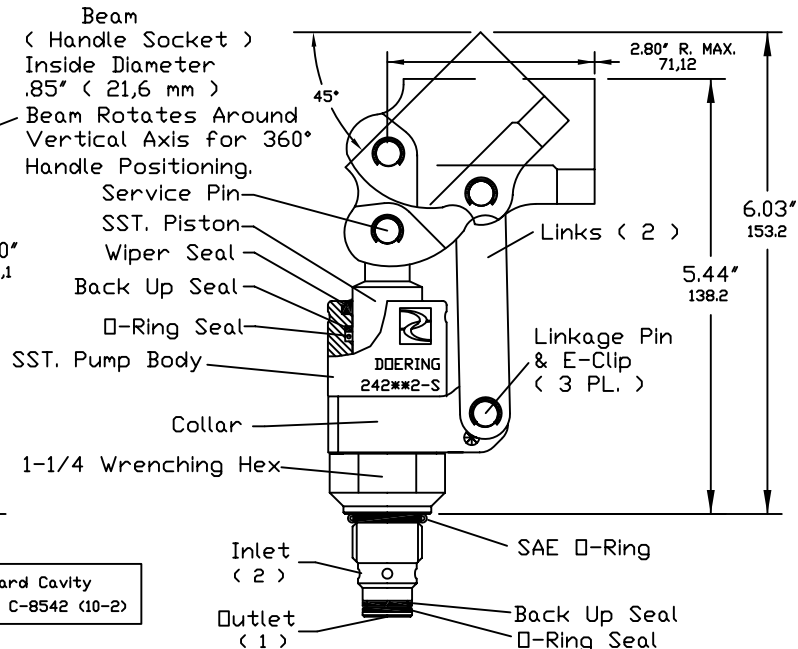

Fits Standard Cavity
Reference: C-8542 (10-2)

FEATURES

Wetted parts are SST. Beam and Collar are Electroless Nickel plated Carbon Steel. For all SST, order -SS Guided, Sprung Checks. Bubble Tested outlet. Operates in any position. Rated to 5000 PSI back pressure at port 1. Ability to generate PSIG determined by piston size. See SELECTION GRAPH.

CAVITY

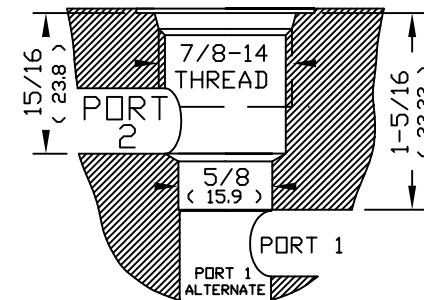

Cavity Spec. Sheet 1200621
Cavity C-8542 (10-2 Industry)
Reference Form Tool: FT-8542

PUMP SELECTION GRAPH

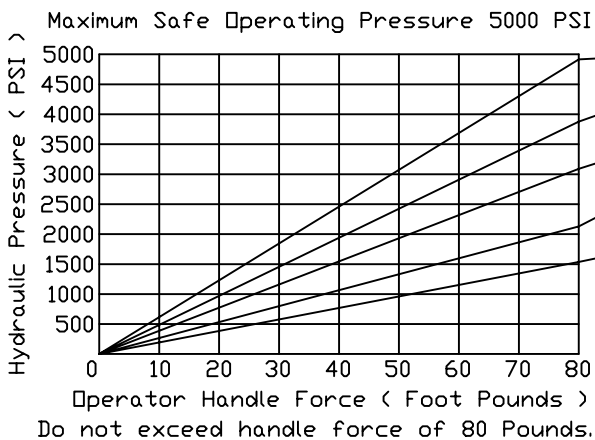

DISPLACEMENT, FULL STROKE		PUSH STYLE ORDER NO.	PULL STYLE ORDER NO.	HOUSING BODY NO.
Cubic Inches	Cubic Centimeters			
.196	3,2cc	242501-S	242502-S	S8542W-## See Spec. Sheet 1201455
.249	4,0cc	242561-S	242562-S	
.307	5,0cc	242621-S	242622-S	
.442	7,2cc	242751-S	242752-S	
.601	9,8cc	242871-S	242872-S	

ACCESSORIES:
Zinc Plated Handle, 16" (406,4 mm), Order No. 241016
SST. Handle, 16" (406,4 mm), Order No. 241016-S
See Handle Spec. Sheet 1201459 for more information.

OPTIONS:
Seal Materials: Call for quotation.

INSTALLATION: Lubricate seals.
Use 1-1/4" Wrench. Torque to approximately 50 Foot Pounds.

Functional Symbol:

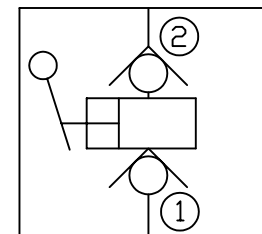

6343 RIVER ROAD SE ■ CLEAR LAKE, MN 55319 USA
Telephone: 320-743-2276 ■ Fax: 320-743-3723
mailto:doering.com ■ www.doering.com



DOERING