

Identification  
Front & Back

Valve Cavity:  
Doering C-8543  
Industry 10-3

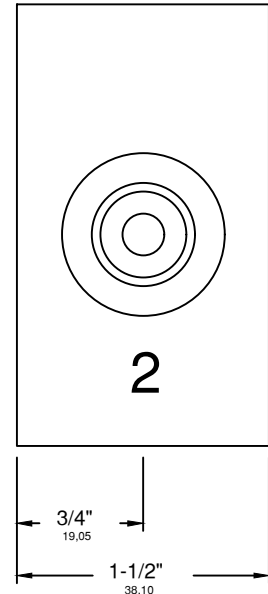
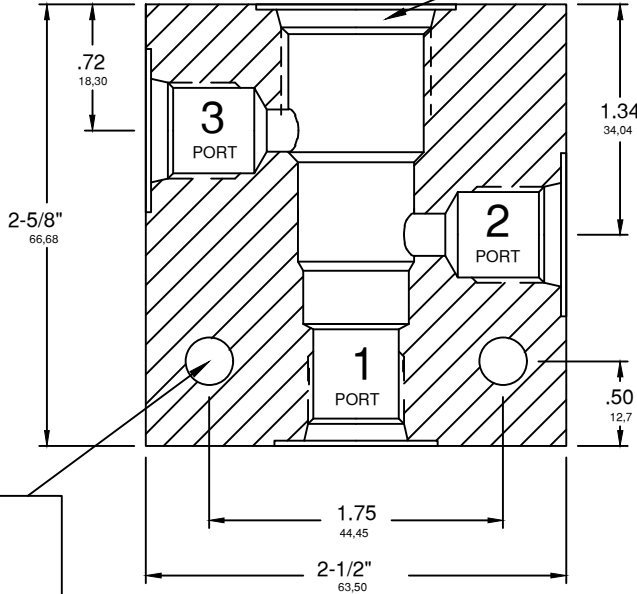
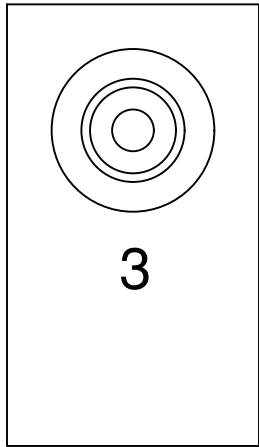

Mounting Holes (2 Pl.)  
 9/32" Diameter,  
 Clearance for 1/4" or M6

### ORDER INFORMATION:

S8543-

Ports 1, 2 & 3

- 1 (1/8 NPT)
- 2 (1/4 NPT)
- 3 (3/8 NPT)
- 4 (SAE4, ORB)
- G4 (G 1/4-19 BSPP)
- 6 (SAE6, ORB)
- G6 (G 3/8-19 BSPP)

Material Option, Pressure Rating

Blank	(6061 Aluminum)	3,000 PSIG
S	(304 Stainless)	5,000 PSIG
S316	(316 Stainless)	5,000 PSIG