

6343 RIVER ROAD SE ■ CLEAR LAKE, MN 55319 USA  
 Telephone: 320-743-2276 ■ Fax: 320-743-3723  
 mailbox@doering.com ■ www.doering.com

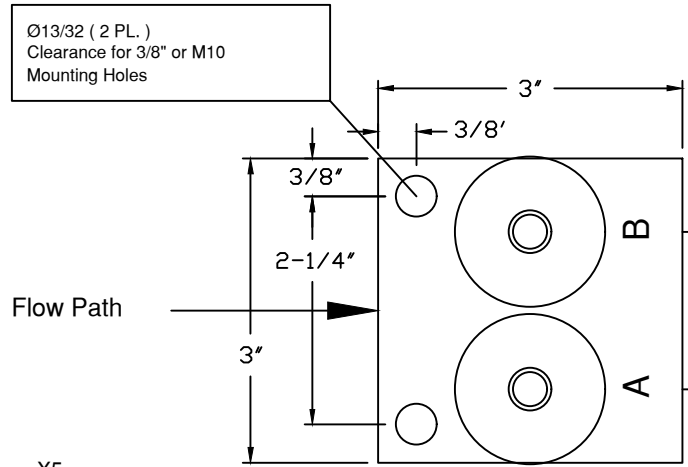

DOERING

**DRAFT**  
**DRAFT**  
 Russ 5/1/10



X Pilots are  
 1/8 NPT Typ.

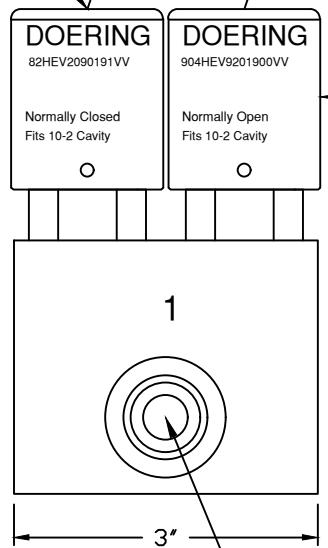

Ø1.50 Typ.

Construction Plug,  
 Brass

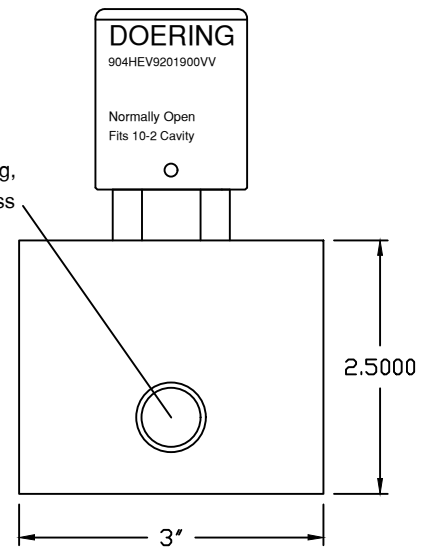

2.5000

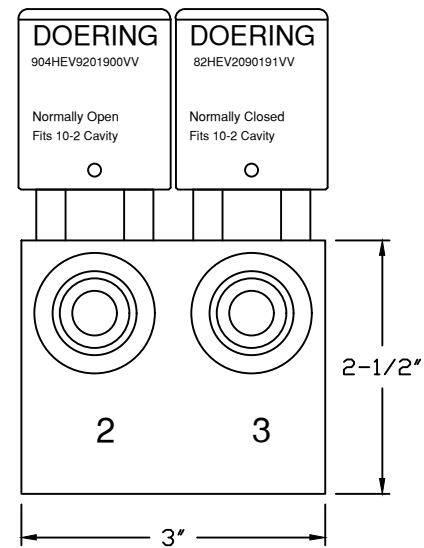

SAE -8 (Ports 1, 2 & 3)

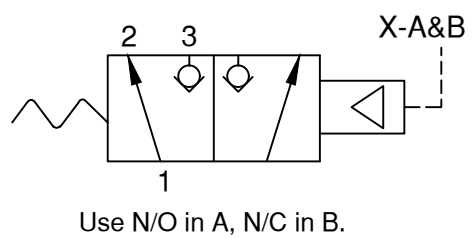

Qty.	Description
	1203194 Assembly of Manifold and 2 Valves
1	1203193 Manifold, Aluminum with Brass Construction Plug.
1	84HEV2090191VV Doering Valve, N/C (Cavity B)
1	904HEV9201900VV Doering Valve, N/O (Cavity A)

SPEC. SHEET NO. 1203194 Draft 5-1-10