

6343 RIVER ROAD SE ■ CLEAR LAKE, MN 55319 USA
Telephone: 320-743-2276 ■ Fax: 320-743-3723
mailto:mailbox@doering.com ■ www.doering.com

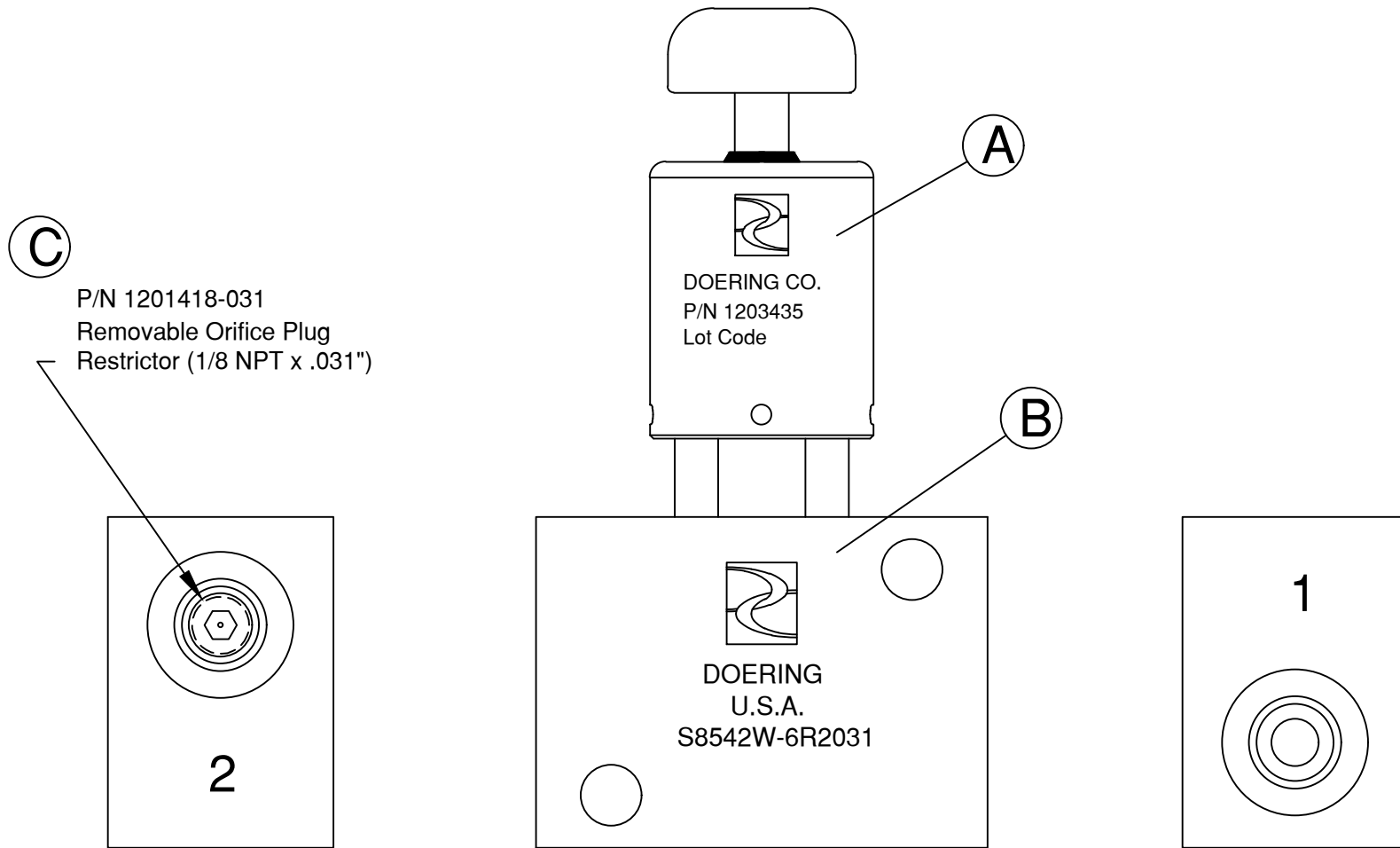
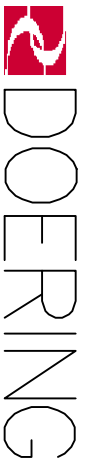

Order No. 1203440 Doering Assembly

Following Items are assembled and become 1203440 Doering Assembly:

Key A: 1203435 Doering Cartridge Valve, N/O, Spec. Sheet 1203435

Key B: S8542W-62R031 Doering Housing, Spec. Sheet 1201455 Page 1 and 2.

Key C: 1201418-031 1/8 NPT x 031 ID Restrictor, Brass (no tape or sealant used)